



# **WELCOME**

## **TO THE UNIVERSITY OF PARDUBICE**

### **INFORMATION FOR INTERNATIONAL GUESTS**





|  |    |
|--|----|
| Travel information.....                              | 4  |
| Accommodation in Pardubice.....                      | 6  |
| The University: Rich Tradition.....                  | 7  |
| The University of Pardubice: Modern and Dynamic..... | 8  |
| Services offered by the University of Pardubice..... | 10 |
| Contacts at the University.....                      | 11 |
| The City of Pardubice.....                           | 14 |
| History of Pardubice.....                            | 15 |
| Where to go in Pardubice in your free time.....      | 16 |
| Restaurants and Cafés in Pardubice.....              | 18 |



## TRAVEL INFORMATION

### FROM PRAGUE AIRPORT TO PRAGUE MAIN RAILWAY STATION:

#### : Option 1

You can take the airport express (AE) bus (<https://www.cd.cz/en/dalsi-sluzby/navazna-doprava/-27548/>). The AE bus runs daily every 30 minutes and the route takes about 40 minutes.

The ticket for the AE bus can be purchased in cash/by card from the bus driver and costs 100 CZK (approx. 4€). The last (and only) stop of the AE bus is the Main Railway Station. To get to the trains, please take the lift or the escalator inside the main railway station building.

#### : Option 2

Take **bus no. 59** (in front of the terminal) to the "Nádraží Veveslavín" metro station (on the subway Green Line A). Take the **subway** from the "Nádraží Veveslavín" metro station (Green Line A) in the direction of Depo Hostivař to the "Muzeum" metro station. At the "Muzeum" metro station, change to the Red Line C (follow the signs) and take the subway in the direction of Letňany to the "Hlavní nádraží" metro station. OR Walk from the "Muzeum" metro station to the "Hlavní nádraží". (Hlavní nádraží means Main Railway station). It takes 10 minutes.

 Find the info on public transport in Prague here: <https://pid.cz/en/tickets-and-fare/how-to-buy-ticket/>

#### : Option 3

Another possibility how to get to the railway station is the taxi. There are marked places for the taxis at the airport; the airport is served by the company Uber. You can book your ride using the Uber app, self-service kiosks, or service counters. For more information, see <https://www.prg.aero/en/taxi>. The price for the taxi from the airport to the main railway station is about 700 CZK (approx. 30 €)

### FROM THE PRAGUE MAIN RAILWAY STATION TO PARDUBICE

You need to get a train going to the Pardubice Hlavní nádraží (Pardubice main station). The easiest option is to take trains from a company called České Dráhy (Czech railways, abbreviated as ČD). The price of the cheapest ticket from Prague to Pardubice is approx. 200 CZK (8,5 €) and the trains run daily every hour.

There are other companies such as RegioJet RJ (<https://novy.regiojet.cz/en>) or Leo Express LE (<https://www.leoexpress.com/en>) and both have sales points at the main railway station in Prague. It is also possible to book the tickets online.

You can search for suitable train, bus and public transport connections at the following link:

<https://idos.idnes.cz/en/vlakyaubusymhdvse/spojeni/>

## FROM PARDUBICE MAIN RAILWAY STATION TO THE UNIVERSITY OF PARDUBICE:

In Pardubice, you can use public transport (see <https://www.dpmp.cz/>).

Once you arrive in Pardubice, you can go to the University of Pardubice by bus no. 30 or 16: Get off the bus at the "Univerzita" bus stop. The price of the bus ticket is 50 CZK (on the bus) or 28 CZK (at points of sale or ticket vending machines). You can also pay on the bus with your bank card: hold the card near the machine on the bus until you hear a beeping sound. Do not forget to do that once again just before you leave the bus. The amount will be deducted from your account.

### : TAXI

You will find „Vi3" taxi in front of the main railway station on the right side, next to Jan Perner's statue. You can also call +420 778 158 158 in case the taxi is not there. They charge approximately 110 CZK (4,5 €). Ask the taxi driver to drop you off near the bus stop "Univerzita".

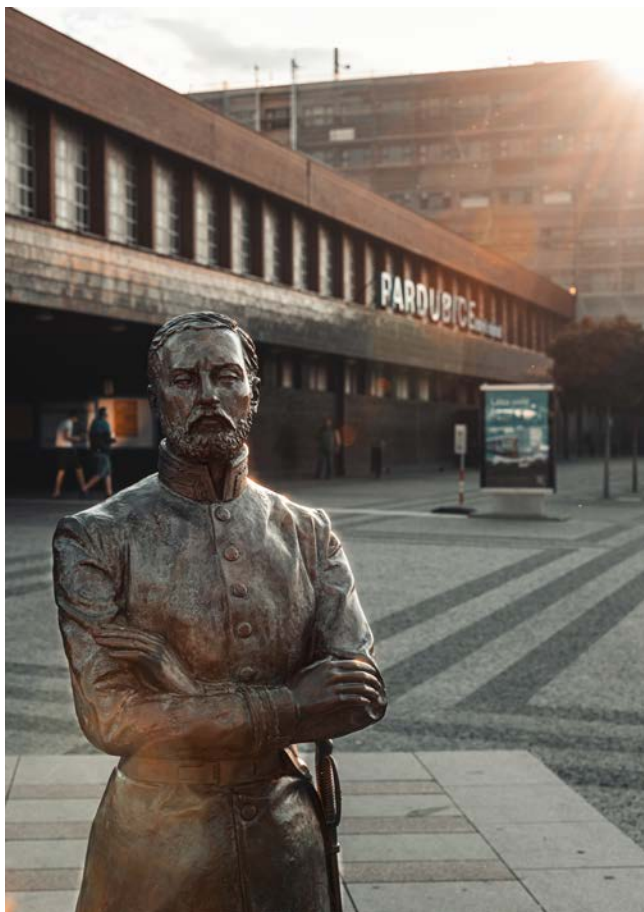



## ACCOMMODATION IN PARDUBICE

Would you like to be accommodated on the campus? Please have a look on <https://www.upce.cz/en/accommodation-of-guests> and contact [ubytovani@upce.cz](mailto:ubytovani@upce.cz) to book your accommodation with the University of Pardubice. If you prefer to be accommodated in a hotel, please see the possibilities below:

### : Austria Pension and Restaurant

📍 [Smilova 312, 530 02 Pardubice](#)

☎ +420 466 649 041

✉ [info@pensionaustria.cz](mailto:info@pensionaustria.cz)

🌐 [www.pensionaustria.cz](http://www.pensionaustria.cz)

### : Hacienda Ranchero

📍 [Za Pasáží 149, 530 02 Pardubice](#)

☎ + 420 469 313 320

✉ [info@haciendaranchero.cz](mailto:info@haciendaranchero.cz)

🌐 [www.haciendaranchero.cz](http://www.haciendaranchero.cz)

### : Hotel 100

📍 [Kostelní 100, 530 02 Pardubice](#)

☎ +420 603 140 187, +420 466 511 179

✉ [hotel100@hotel100.cz](mailto:hotel100@hotel100.cz)

🌐 [www.hotel100.cz](http://www.hotel100.cz)

### : Hotel Atrium

📍 [Smilova ulice 343, 530 02 Pardubice](#)

☎ +420 466 615 146

✉ [info@hotelatrium.cz](mailto:info@hotelatrium.cz)

🌐 [www.hotelatrium.cz/en](http://www.hotelatrium.cz/en)

### : Hotel Euro

📍 [Jiráskova 2781, 530 02 Pardubice](#)

☎ +420 466 414 255

✉ [info@hoteleuro.cz](mailto:info@hoteleuro.cz)

🌐 [www.hoteleuro.cz](http://www.hoteleuro.cz)

### : Hotel Staré Časy

📍 [Havlíčková 1080, 530 02 Pardubice](#)

☎ +420 466 512 221, +420 466 536 063

✉ [info@stare-casy.cz](mailto:info@stare-casy.cz)

🌐 [www.stare-casy.cz](http://www.stare-casy.cz)

### : Hotel Zlatá Štika

📍 [Štrossova 127, 530 03 Pardubice](#)

☎ +420 466 052 100, +420 603 201 700

✉ [recepce@zlatastika.cz](mailto:recepce@zlatastika.cz)

🌐 [www.zlatastika.cz](http://www.zlatastika.cz)

### : Pension & Restaurant Birdie

📍 [Hlaváčova 392, 530 02 Pardubice](#)

☎ +420 466 053 250, +420 777 931 170

✉ [info@birdie.cz](mailto:info@birdie.cz)

🌐 [www.birdie.cz](http://www.birdie.cz)

### : Penzion Zelená Žába

📍 [Hronovická 929, 530 02 Pardubice](#)

☎ +420 777 086 017

✉ [info@zelenazaba.cz](mailto:info@zelenazaba.cz)

🌐 [www.zelenazaba.cz](http://www.zelenazaba.cz)

### : Pierre hotel & restaurant

📍 [Kunětická 227, Pardubice, 530 09](#)

☎ +420 778 511 677

✉ [info@pierrehotel.cz](mailto:info@pierrehotel.cz)

🌐 [www.pierrehotel.cz](http://www.pierrehotel.cz)



The University of Pardubice (<https://www.upce.cz/>) was established as a Chemical Institute in 1950.

The tradition of higher education in Pardubice dates back to the first months after the Second World War and is very closely connected to the development of the transport network and food, machine and chemical industry in the city and the region. In the autumn of 1945, local chemical factories suggested the establishment of a chemical college in Pardubice. Five years later, on 27 June 1950, the Czech government established the Chemical College. Classes started on 15 October 1950.

In November 1953, the school became an independent body as the Institute of Chemical Technology headed by a Rector. In 1991, an important restructuring of the Institute took place and brought into existence two faculties, the Faculty of Chemical Technology and the Faculty of Public Administration. This newly established Faculty, in 1993 renamed the Faculty of Economics and Administration, answered the call for professionally trained specialists for local state and municipal authorities and private businesses. In 1992, the Institute of Languages and Humanities was established in compliance with a project suggested by the Ministry of Education to meet the constant need for qualified teachers of foreign languages at elementary schools. In the late 1990s, the Institute became the core of the future fourth Faculty oriented towards Philology and Social Sciences, offering BA and MA degree courses. Social and economic changes in the society and the formation of the new independent Czech Republic in 1993 became the major stimulus for the establishment of the Transport Faculty. As the Institute of Chemical Technology and the city of Pardubice were able to offer the necessary backing for the new Faculty, the Jan Perner Transport Faculty could be established on 1 April 1993. The new Faculty bears the name of Jan Perner, an outstanding 19th century railway engineer. Bachelor's and master's degree courses are complemented by doctoral study programmes, and the Faculty also has the right to professorial appointment procedures. In 2017, the Faculty was renamed the Faculty of Transport Engineering.

Since 31 March 1994, the original Institute of Chemical Technology has the status of a university under the new name Univerzita Pardubice (University of Pardubice).

Another important chapter of the history of higher education in Pardubice began in January 2001, when the Faculty of Humanities was established from the Institute of Languages and Humanities. In 2004, the Faculty was renamed the Faculty of Arts and Philosophy.

In 2002, two new institutes were established, namely the Institute of Informatics, later renamed as the Institute of Electrical Engineering and Informatics, focused on modern information technologies and electrical engineering, and the Institute of Health Studies.

In July 2005, a new artistic faculty was established in Litomyšl: the Faculty of Restoration, which continues to broaden the educational, scientific activities and applied international projects in the field of arts, art restoration techniques and technologies that have been taking place in the city of Litomyšl since 1993. The Faculty is one of only a handful of Czech institutions that provide higher education in the field of art restoration.

On 1 January 2007, the Institute of Health Studies became the Faculty of Health Studies, which provides education in nursing and midwifery.

On 1 January 2008, the Institute of Electrical Engineering and Informatics became the Faculty of Electrical Engineering and Informatics.



## THE UNIVERSITY OF PARDUBICE: MODERN AND DYNAMIC

Seven faculties, 7,000 students, well-equipped classrooms and laboratories, top scientific teams and institutional accreditation are key features of the University. Chemists and economists, philosophers and historians, health professionals, transport experts, electrical engineers and computer scientists, and restorers study here. According to international ratings, we are one of the best universities in the Czech Republic.

### • The University consists of seven faculties:

Faculty of Chemical Technology <https://fcht.upce.cz/en>

Faculty of Economics and Administration <https://fes.upce.cz/en>

Faculty of Transport Engineering <https://dfjp.upce.cz/en>

Faculty of Arts and Philosophy <https://ff.upce.cz/en>

Faculty of Restoration <https://fr.upce.cz/en>

Faculty of Health Studies <https://fzs.upce.cz/en>

Faculty of Electrical Engineering and Informatics <https://fei.upce.cz/en>

Currently, students can choose from different study programmes in the fields of science and engineering and social sciences in bachelor's, master's and doctoral degree courses. Students may register for full-time or part-time studies. The duration of studies varies according to the chosen course, but generally ranges from three to five years.

The University creates an international and creative environment. We are a respected part of international higher education and science. We address a number of scientific research issues, organise important international meetings, conferences, seminars, and summer schools. We support our students and academics in their foreign activities. Currently, we host more than 500 international students from 80 countries. We have a network of foreign partners as we work with more than 400 higher education and research institutions from 50 countries. We develop the mobility of students and teachers, and we support their participation in and presentation of results at foreign partner departments abroad.

For information about **Study Programmes**, please visit <https://studuj.upce.cz/en>.

For information about **Courses and Departments** please visit: <https://www.upce.cz/en/study/exchange-programmes/ects-catalogue.html>

### • Research and Development

Excellent results have been achieved thanks to our academic staff, students and graduates. We publish our research results in internationally recognised journals (350 publications per year) and are involved in domestic and international scientific projects and consortiums (currently 250 projects). Our scientific and research results have made us a recognised educational institution creating independent scientific schools.

We have long excelled in a number of scientific disciplines such as Analytical Chemistry, Mate-



rials Science (Ceramics), Condensed Matter Physics, Biochemical Research Methods, Thermodynamics, Optics, Electrochemistry, Polymer Science, Materials Science (Textiles), Molecular Physics and Physical Chemistry. We are leaders among Czech universities mainly in the fields of Analytical Chemistry, Biochemical Research Methods and Thermodynamics. This is evidenced by the summary citation response. We rank second in the field of Optics and fourth in the field of Condensed Matter Physics. In the social sciences and humanities, our publications are concentrated mainly in books and monographs.

International cooperation is an integral part of quality scientific work and, above all, it is essential in the long term in building viable creative teams. The University maintains intensive international cooperation, especially in the field of doctoral study programs.

For more information about the University of Pardubice, please visit [https://www.upce.cz/sites/default/files/global/2025-08/15108/University%20of%20Pardubice\\_120616.pdf](https://www.upce.cz/sites/default/files/global/2025-08/15108/University%20of%20Pardubice_120616.pdf)

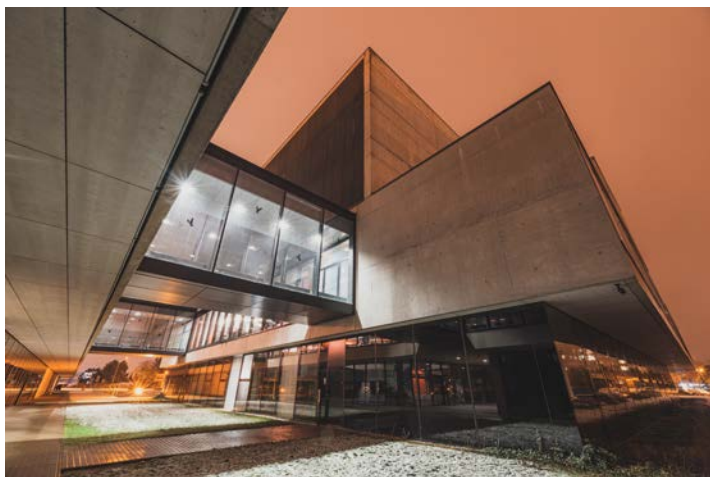
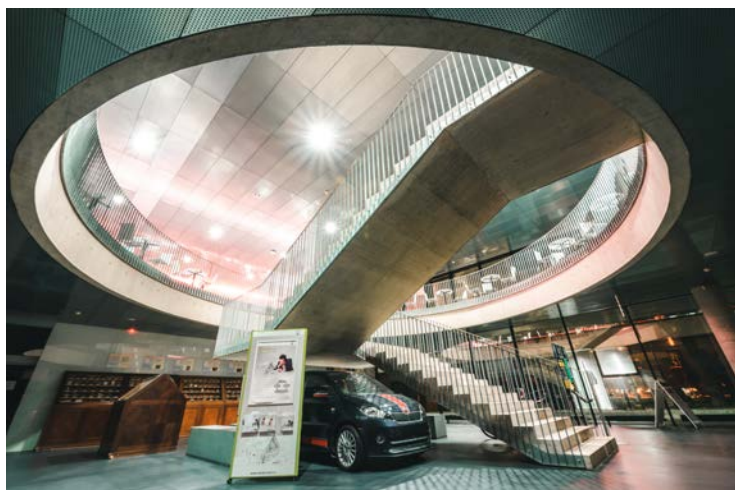



## SERVICES OFFERED BY THE UNIVERSITY OF PARDUBICE

Our modern and well-equipped University Campus is situated just a few minutes away from the town centre. You will find everything you need in one spot: classrooms, laboratories, lecture halls, a modern university library, art gallery, copy centre, dormitories, as well as dining halls.

You can try our dining hall that is located on the campus (letter M on the map below). Please also see <https://www.upce.cz/en/catering>. Furthermore, you can get a coffee in the Bistro Zastávka at the Faculty of Transport Engineering or in Laborka at the Faculty of Chemical Technology.

We create ideal study conditions for the well-rounded development of young people to improve their ability to succeed in life. Our students are involved in cultural and sports activities, as well as social clubs.



**: UNIVERSITY OF PARDUBICE****International Office**

📍 Studentská 95, 532 10 Pardubice, Czech Republic

☎ +420 724 871 642 (emergency)

✉ mobility@upce.cz

**Head of International Office, Erasmus+ Institutional Coordinator**

(Inter-institutional agreements, Outgoing staff)

Ms. Věra Albrechtová

☎ +420 466 036 350

✉ vera.albrechtova@upce.cz

**Mobility Coordinator**

(Incoming students, CEEPUS coordinator)

Ms. Martina Votoupalová

☎ +420 466 036 445

✉ martina.votoupalova@upce.cz

**International Relations Coordinator**

(Incoming staff, EURAXESS coordinator, Incoming PhD students)

Ms. Libuše Cermanová

☎ +420 466 036 508

✉ libuse.cermanova@upce.cz

**Erasmus+ Mobility Coordinator**

(Outgoing students)

Ms. Dominika Čvančarová

☎ +420 466 036 496

✉ dominika.cvancarova@upce.cz

**International Relations Officer**

(Financial specialist)

Ms. Kateřina Pešková

+420 466 036 725

katerina.peskova@upce.cz

**Healthcare Club**

(if you have health issues)

+420 724 878 439

healthcare@upce.cz

**: UNIVERSITY OF PARDUBICE – FACULTIES****Faculty of Arts and Philosophy**

Internationalisation Coordinator

Ms. Ms. Kateřina Mazurová

katerina.mazurova@upce.cz

**Faculty of Chemical Technology**

Internationalisation Coordinator

Mr. Jana Košťálová

+420 466 037 789

jana.kostalova@upce.cz

**Faculty of Economics and Administration**

Internationalisation Coordinator

Mr. Jan Vacek

+420 466 036 072

jan.vacek@upce.cz

**Faculty of Electrical Engineering and Informatics**

Internationalisation Coordinator

Mr. Zdeněk Němec

+420 466 036 449

zdenek.nemec@upce.cz

**Faculty of Health Studies**

Internationalisation Coordinator

Ms. Drahomíra Ciberová

+420 466 037 804

drahomira.ciberova@upce.cz

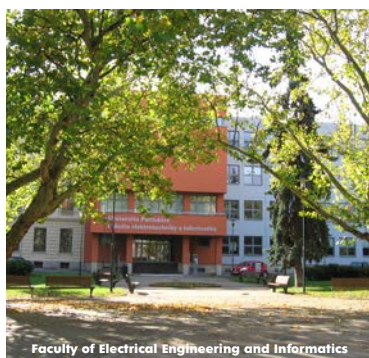

**Faculty of Restoration**

Internationalisation Coordinator

Ms. Pavla Nováková

☎ +420 466 036 592

✉ pavla.novakova@upce.cz

**Faculty of Transport Engineering**

Internationalisation Coordinator

Ms. Nela Dosedělová

☎ +420 466 036 704

✉ nela.dosedelova@upce.cz



Faculty of Transport Engineering



Faculty of Restoration



Faculty of Arts and Philosophy



Faculty of Chemical Technology



Faculty of Health Studies





The City of Pardubice (<https://www.pardubice.eu/en/>) is located in East Bohemia. It is 100 km east of the Czech capital Prague, and 150 km northwest of the second largest Czech city, Brno. Pardubice, the capital city of Pardubice Region, has a population of over 90 000 people and is situated in the flat lowlands of the Elbe and Chrudimka rivers. The weather is warm during summertime – around 25°C/30°C (77°F/86°F). Winter temperatures can drop to around -10°C/-15°C (14°F/-5°F).

Pardubice is an important transportation hub. Part of Pardubice's appeal is its proximity to all regions and major cities in the Czech Republic. The city also hosts an international airport (<https://airport-pardubice.cz/en/home/>). Pardubice's industry specialises primarily in chemical engineering, electrotechnical engineering and in the automotive industry.

Pardubice is a city that is well known for its diverse culture, sporting events, entertainment events and environmental organisations. The Great Pardubice Steeplechase (<https://zavodis-tepardubice.cz/en/>) is the oldest and the most difficult horse race on the continent, dating back to 1874. Pardubice's Speedway Golden Helmet (<http://www.zlataprilba.cz/>) is the oldest motorcycle speedway race in the world. There is an International Chess Competition – the Czech Open, several marathons and bicycle races, an outdoor summer cinema, music festivals, and an annual wine festival. These are just a few of Pardubice's many events and offerings.

The city is characterised by its beautiful countryside; the nature offers a convenient environment and opportunities for swimming, water sports, running, cycling, and rollerskating. The city has its own ice hockey club that plays in the Czech Extraligue.

Gingerbread is a symbol that is inseparable from the city of Pardubice; it has a long history and has been a tradition in Pardubice since the 16th century. There is a Gingerbread and fairy tale museum near the Kunětická Hora Castle. Gingerbread is also Pardubice's most traditional souvenir. The courtyard of the Pardubice Château is home to the Gingerbread Festival every May.

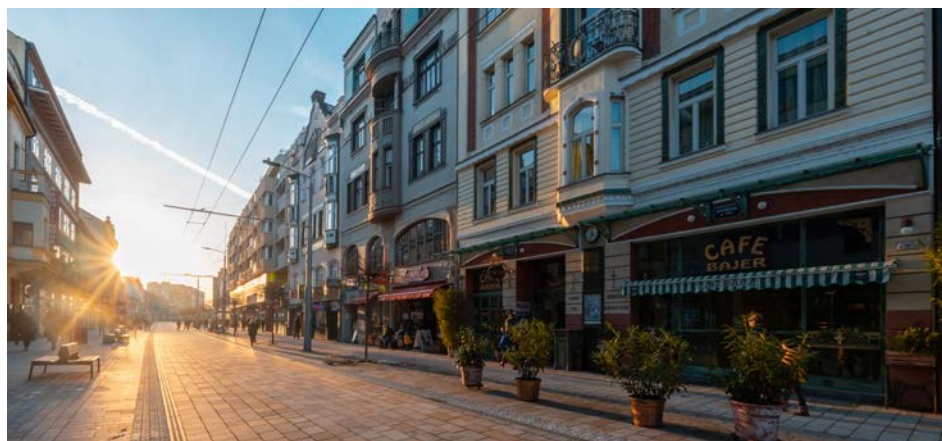



## HISTORY OF PARDUBICE

The first ancient written records of Pardubice date back to the late 13th century; since then, Pardubice has developed a rich and exciting history that shapes our region. Looking around the city of Pardubice, you will notice the Gothic and Renaissance architecture.

In 1491, the most powerful nobleman of the Czech Kingdom, Vilém of Pernštejn, bought the town. The town flourished under his ownership. He rebuilt the former water castle into a comfortable palace in the late Gothic style surrounded by a massive fort. His sons Vojtěch and Jan then continued the reconstruction in the Renaissance style. The Pernštejn family contributed to the reconstruction of the town, mainly the historic city center with Renaissance square, picturesque streets and the dominant feature of the town – the Green Gate.

However, the region went into debt and in 1560 the Pernštejn family sold it to the Habsburg family. The town went into decline afterwards and the Thirty Years' war impoverished the city even more.

The city developed again in the first half of the 19th century. In 1845, the railway was finished and the first train came to Pardubice on its way from Olomouc to Prague. The railway network was developed further and new industrial firms arose.





## WHERE TO GO IN PARDUBICE IN YOUR FREE TIME

**Pernštejn Square** is the city's natural and historic centre. Its major landmarks include the **Neo-Renaissance town hall** and the **Pardubice Chateau**, which is an extremely valuable monument. The most famous sites in Pardubice are the **Green Gate**, which provides a picturesque view over the city, and **Kunětická hora Castle**, which is located 6 km from the city centre and open to the public as a museum. If you are interested in the architecture of the 20th century, you can visit the art-nouveau **East Bohemian Theatre** Pardubice, built between 1906 and 1909, the art deco **Passage** designed by Ladislav Machoň or **Automatic Mills** built according to the design of the famous architect Josef Gočár in 1910.

In your free time, you can enjoy shopping in Třída Míru or the **Atrium** shopping centre, you can visit the **East Bohemian Museum** in the Pardubice Chateau or the **East Bohemian Gallery** or take a boat trip with the Arnošt. For those who want to do some sports, you can go swimming in the Pardubice **Aquatic Centre** or **rent a bike** at the main railway station and get to know the city and surroundings another way.

### Addresses:

#### Pernštejn Square and town hall

📍 [Pernštýnské náměstí, 530 02 Pardubice](#)

#### Pardubice Chateau and East Bohemian Museum

📍 [Zámek čp. 2, 530 02 Pardubice](#)

🕒 **Opening hours:** <https://www.vcm.cz/en/visit/oteviraci-doba-a-vstupne/>

#### Green Gate

📍 [Zelenobranská 76, 530 02 Pardubice](#)

🕒 **Opening hours:** <https://www.zelenabrana.eu/cs/oteviraci-doba-a-cenik>

#### Kunětická hora Castle

📍 [Ráby 6, 533 52 Staré Hradiště](#)

🕒 **Opening hours:** <https://www.hrad-kunetickahora.cz/en/plan-your-visit/opening-hours>

#### East Bohemian Theatre

📍 [U Divadla 50, 531 62 Pardubice](#)

🌐 <https://www.vcd.cz/>

#### Machoňova pasáž (Passage)

📍 [Třída Míru 60, 530 02 Pardubice](#)

#### Automatic Mills

📍 [Mezi Mosty 436, 53003 Pardubice](#)

🌐 <https://automatickemlynny.eu/>



**Atrium Shopping Centre**

📍 [Masarykovo nám. 2799, 530 02 Pardubice](#)

🌐 <https://palacpardubice.cz/en/>

**East Bohemian Gallery**

📍 [Pernštýnské nám. 50, 530 02 Pardubice](#)

🕒 **Opening hours:** <https://vcg.cz/cs/pro-navstevniky/oteviraci-doba>

**Aquatic Centre**

📍 [Jiráskova 2664, 53002 Pardubice](#)

🌐 <https://www.aquapce.cz/oteviraci-doba/>

**Rent a bike – Pardubice railway station**

📍 [Náměstí Jana Pernera](#)

🌐 <https://www.cd.cz/en/dalsi-sluzby/pujcovny-kol-cd-bike/default.htm>

**Rental fee (bike+helmet):** 245 CZK/day + 2000 CZK refundable deposit

**Groceries**

[Lidl near the University](#)

[Tesco in the city](#)





## RESTAURANTS AND CAFÉS IN PARDUBICE

Would you like to taste traditional Czech food like "Svíčková", "Řízek" or "Španělský ptáček"? You'll find traditional Czech cuisine at Bohémská hospoda and Beseda, while more modern dishes are served at Nejen DVOREK and Bonté. If you are looking for specialties from the grill, you can try the restaurant Restaurace Na Staré Rybárně.

### : Beseda

📍 [Smetanovo náměstí 47, Pardubice](#)

☎ +420 727 806 130

📧 <https://www.besedapardubice.cz/>

### : Bohémská hospoda

📍 [Pernštýnské nám. 4, Pardubice I](#)

☎ +420 776 694 560

📧 <https://bohemskehospoda.cz/>

### : Bonté restaurant

📍 [Masarykovo náměstí 1458, Pardubice](#)

☎ +420 731 582 989

📧 [bonte@bonte.cz](mailto:bonte@bonte.cz)

📧 <https://bonte.cz/>

### : Café Bajér

📍 [Třída Míru 763, Pardubice](#)

☎ +420 466 511 265

📧 [cafebajer@atlas.cz](mailto:cafebajer@atlas.cz)

📧 [www.cafebajer.cz](http://www.cafebajer.cz)

### : Galerie Café

📍 [Sukova třída - Tyršovy sady, Pardubice](#)

☎ +420 773 011 021

📧 [galeriecafe@holflor.cz](mailto:galeriecafe@holflor.cz)

📧 <https://www.galeriecafepardubice.cz/>

### : Kafe, víno, kokino

📍 [U Divadla 620, Pardubice](#)

☎ +420 773 053 981

📧 [kavarna@kafevinokokino.cz](mailto:kavarna@kafevinokokino.cz)

📧 <https://www.kafevinokokino.cz/>

### : Nejen DVOREK

📍 [třída Míru 66, Pardubice](#)

☎ +420 777 166 065

📧 [info@nejendvorek.cz](mailto:info@nejendvorek.cz)

📧 [www.nejendvorek.cz](http://www.nejendvorek.cz)

### : Restaurace Na Staré Rybárně

📍 [Bulharská 1784, Pardubice](#)

☎ +420 466 614 056

📧 [info@nastarerybarne.cz](mailto:info@nastarerybarne.cz)

📧 [www.nastarerybarne.cz](http://www.nastarerybarne.cz)

### : Tasty restaurant

📍 [Havlíčková 445, Pardubice](#)

☎ +420 777 157 337

📧 [info@tastyrestaurant.cz](mailto:info@tastyrestaurant.cz)

📧 <https://tastyrestaurant.cz/>







UNIVERSITY  
OF PARDUBICE

